

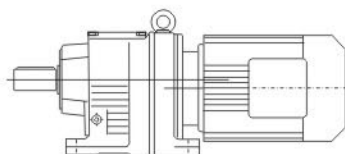

R系列斜齿轮硬齿面减速机



R系列减速机有以下设计方案：



R...Y...
底脚轴伸式安装斜齿轮减速机

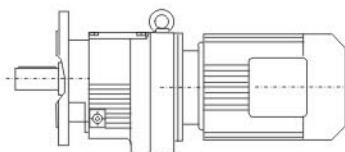

RF...Y...
法兰轴伸式安装斜齿轮减速机

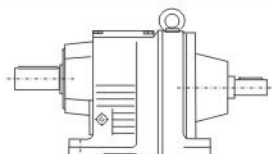

RS (双轴型) ...
底脚轴伸式安装，轴输入的斜齿轮减速机

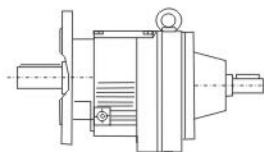

RFS (双轴型) ...
法兰轴伸式，轴输入的斜齿轮减速机

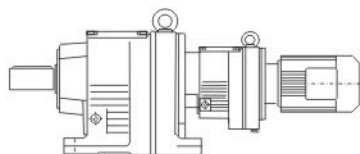

R...R...Y...
底脚轴伸式安装组合型斜齿轮减速机

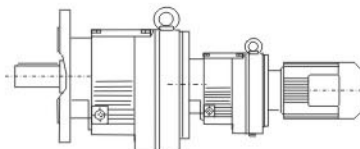

RF...R...Y...
法兰轴伸式组合型斜齿轮减速机



R...R...
底脚轴伸式安装组合型，轴输入的斜齿轮减速机

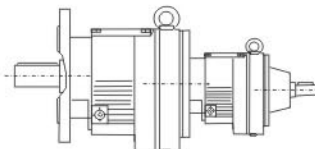

RF...R...
法兰轴伸式组合型，轴输入的斜齿轮减速机

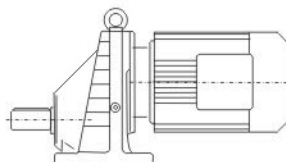

RX...Y...
底脚轴伸式安装单级斜齿轮减速机

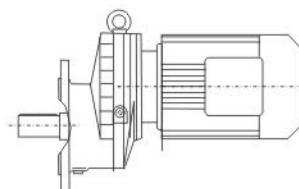

RXF...Y...
法兰轴伸式安装单级斜齿轮减速机

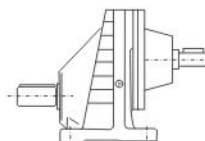

RXS (双轴型) ...
底脚轴伸式安装，轴输入的单级斜齿轮减速机

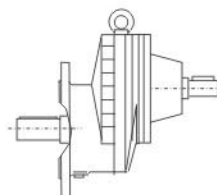

RXFS (双轴型) ...
法兰轴伸式，轴输入的单级斜齿轮减速机

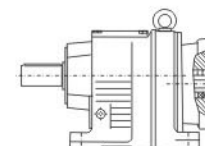

R (RF, RX, RXF) ...ZP...
电机用户自配或配特殊电机时



型号与标记:

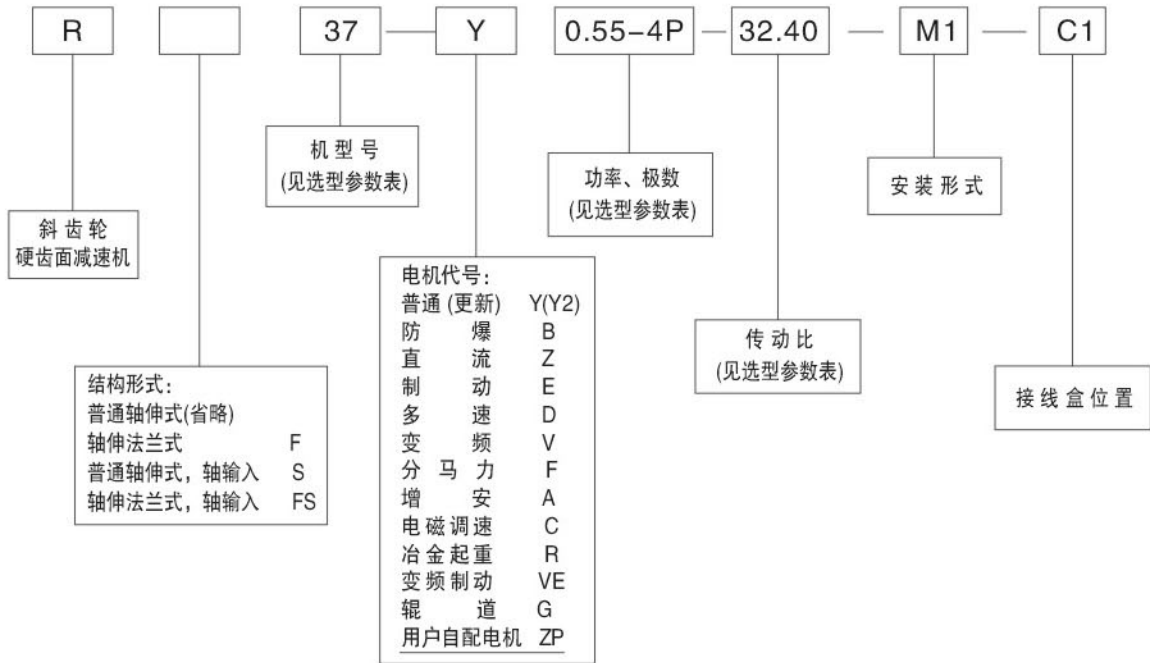

安装形式:

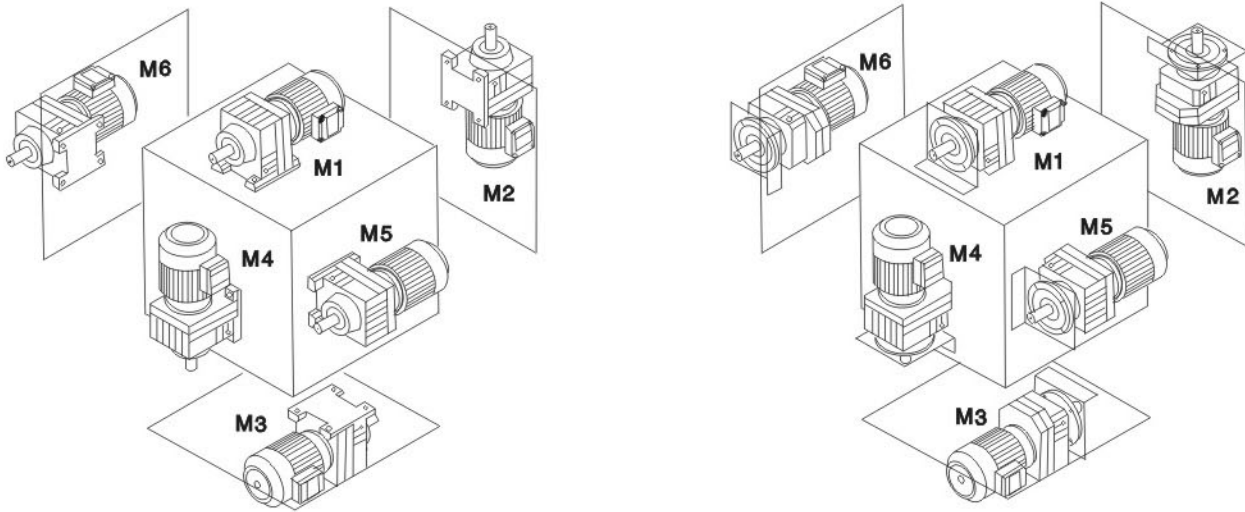

电机接线盒位置:

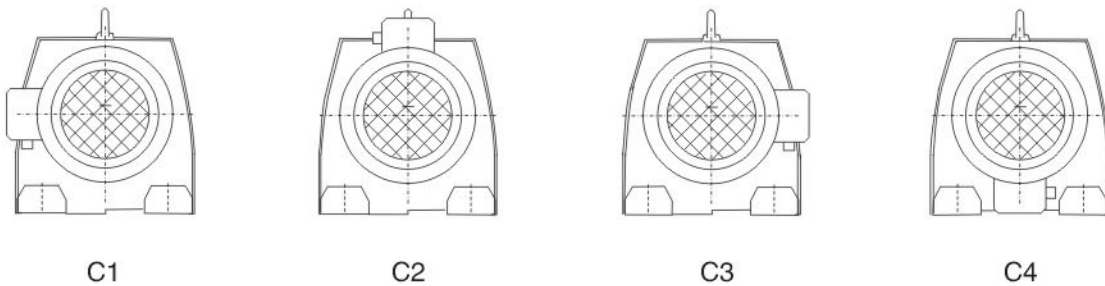



选型指南

输入功率及许用转矩

机型号	17	27	37	47	57	67	77	87	97	107	137	147	167
结构形式	R						RF						
输入功率 (KW)	0.18~0.75	0.18~3	0.18~3	0.18~5.5	0.18~7.5	0.18~7.5	0.18~11	0.55~18.5	0.55~30	2.2~45	5.5~55	11~90	11~160
传动比	3.83~74.84	3.37~135.09	3.33~134.82	3.83~176.88	4.39~186.89	4.29~199.81	5.21~195.24	5.36~246.54	4.49~289.74	5.06~249.16	5.15~222.60	5.00~163.31	10.24~229.71
许用转矩 (N.m)	85	130	200	300	450	600	820	1550	3000	4300	8000	13000	18000

机型号	37	57	67	77	87	97	107	127	157
结构形式	RX					RXF			
输入功率 (KW)	0.18~1.1	0.18~5.5	0.18~7.5	1.1~11	3~22	5.5~30	7.5~45	7.5~90	11~132
传动比	1.62~4.43	1.3~5.5	1.4~6.07	1.42~8.00	1.39~8.65	1.42~8.23	1.44~6.63	1.51~6.2	1.57~6.2
许用转矩 (N.m)	20	70	135	215	400	600	830	1110	1680

减速机重量

机型号	R17	R27	R37	R47	R57	R67	R77	R87	R97	R107	R137	R147	R167
重量 (kg)	4	5.5	8.5	10	18	25	36	63	101	153	220	400	700
机型号	RX37	RX57	RX67	RX77	RX87	RX97	RX107	RX127	RX157				
重量 (kg)	5	8	14	23	39	70	100	150	250				

所注重量为平均值, 仅供参考

产品结构示意图

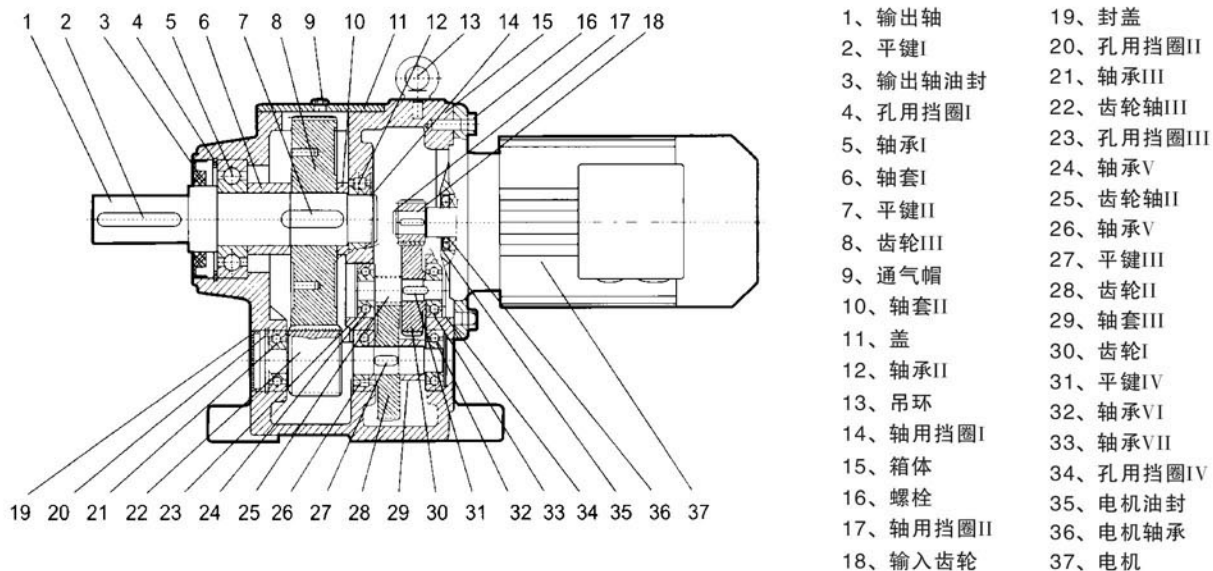



润滑油量表

机型号	润滑油量 (升)					
	M1 1)	M2 1)	M3	M4	M5	M6
R17	0.25	0.6	0.35	0.6	0.35	0.35
R27	0.25/0.4	0.7	0.4	0.7	0.4	0.4
R37	0.3/1	0.9	1	1.1	0.8	1
R47	0.7/1.5	1.6	1.5	1.7	1.5	1.5
R57	0.8/1.7	1.9	1.7	2.1	1.7	1.7
R67	1.1/2.3	2.6/3.5	2.8	3.2	1.8	2
R77	1.2/3	3.8/4.3	3.6	4.3	2.5	3.4
R87	2.3/6	6.7/8.4	7.2	7.7	6.3	6.5
R97	4.6/9.8	11.7/14	11.7	13.4	11.3	11.7
R107	6/13.7	16.3	16.9	19.2	13.2	15.9
R137	10/25	28	29.5	31.5	25	25
R147	15.4/40	46.5	48	52	39.5	41
R167	27/70	82	78	88	66	69

机型号	润滑油量 (升)					
	M1 1)	M2 1)	M3	M4	M5	M6
RF17	0.25	0.6	0.35	0.6	0.35	0.35
RF27	0.25/0.4	0.7	0.4	0.7	0.4	0.4
RF37	0.4/1	0.9	1	1.1	0.8	1
RF47	0.75/1.5	1.6	1.5	1.7	1.5	1.5
RF57	0.8/1.7	1.8	1.7	2	1.7	1.7
RF67	1.2/2.5	2.7/3.6	2.7	3.1	1.9	2.1
RF77	1.2/2.6	3.8/4.1	3.3	4.1	2.4	3
RF87	2.4/6	6.8/7.9	7.1	7.7	6.3	6.4
RF97	5.1/10.2	11.9/14	11.2	14	11.2	11.8
RF107	6.3/14.9	15.9	17	19.2	13.1	15.9
RF137	9.5/25	27	29	32.5	25	25
RF147	16.4/42	47	48	52	42	42
RF167	26/70	82	78	88	65	71

机型号	润滑油量 (升)					
	M1	M1	M3	M4	M5	M6
RX37/RXF37	0.45/0.4	0.6	1.1/0.9	1.1/0.9	0.7/0.6	0.7/0.6
RX57/RXF57	0.6/0.5	0.8	1.3/1.1	1.3/1.1	0.9/0.7	0.9/0.7
RX67/RXF67	0.8/0.7	0.8	1.7/1.5	1.9/1.7	1.1/1	1.1/1
RX77/RXF77	1.1/0.9	1.5	2.6/2.4	2.7/2.5	1.6	1.6
RX87/RXF87	1.7/1.6	2.5	4.8/4.9	4.8/4.7	2.9	2.9
RX97/RXF97	2.1	3.4/3.6	7.4/7.1	7	4.8	4.8
RX107/RXF107	3.9/3.1	5.6/5.9	11.6/11.2	11.9/10.5	7.7/7.2	7.7/7.2
RX127/RXF127	5.6/5.9	11.6/11.2	21.9/20.5	22.7/22.2	9.7/9.2	9.7/9.2
RX157/RXF157	11.6/11.2	21.9/20.5	31.3/30.5	32.7/32.2	13.2/12.7	13.2/12.7

注：1) 表示减速机为组合型时低速级所加油量为大值。



外型安装尺寸

R系列减速机

RX37

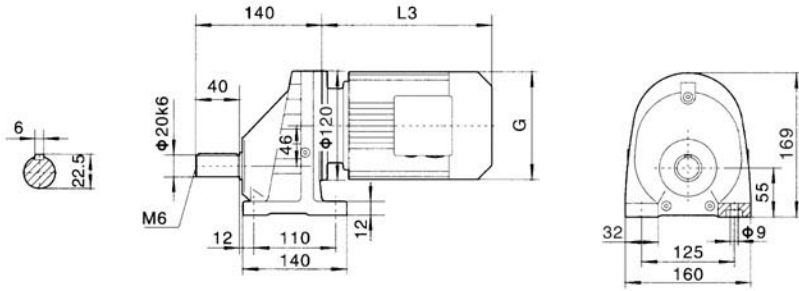

RX..S37

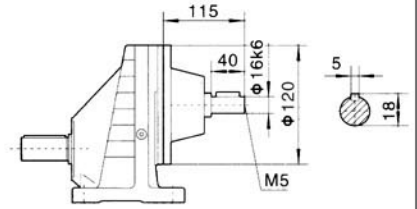

电机需方配时或配特殊电机时需加联接法兰

RXF37

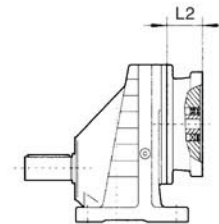
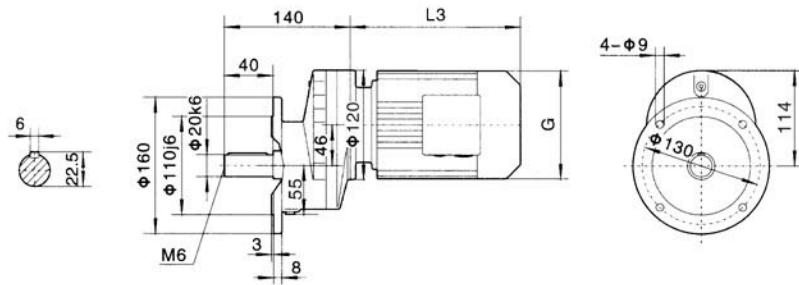

注：其余尺寸见相应的结构形式

Y ₂ 电机机座号	63	71	80	90S	
功率/4P(kw)	0.18	0.25 0.37	0.55 0.75	1.1	
L3	223	236	264	301	
G	130	145	175	195	
L2	71	71	71	71	

注：“RX..”表示RX、RXF



RX57

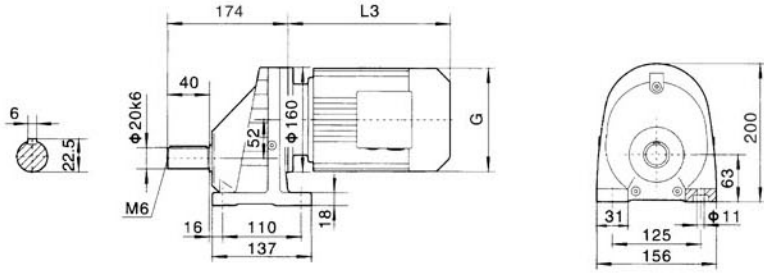

RX..S57

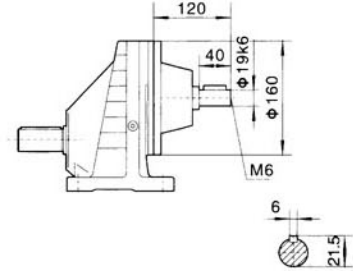

RXF57

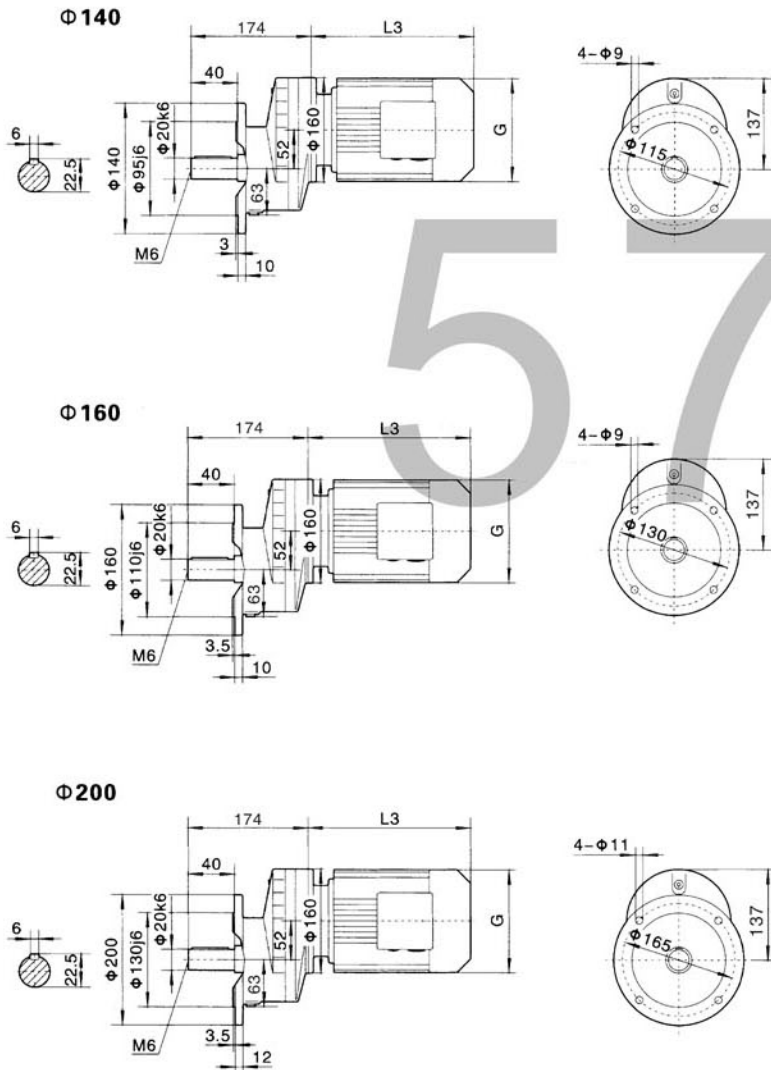

电机需方配时或配特殊电机时需加联接法兰

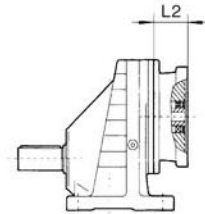

注：其余尺寸见相应的结构形式

Y2电机机座号	63	71	80	90S	90L	100	112M	132S	
功率/4P(kw)	0.18	0.25 0.37	0.55 0.75	1.1	1.5	2.2 3.0	4.0	5.5	
L3	223	245	278	304	328	350	380	425	
G	130	145	175	195	195	215	240	275	
L2	81	81	81	81	81	93	93	101	

注：“RX..”表示RX、RFX



外型安装尺寸

RX67

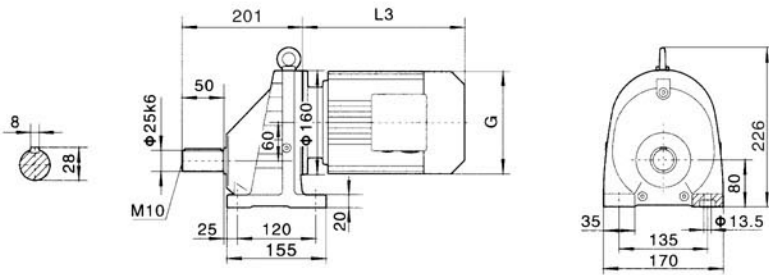

RX..S67

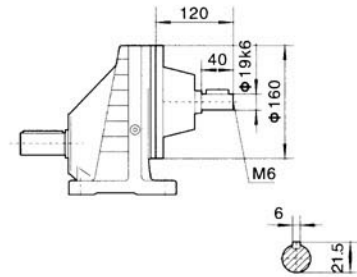

RXF67

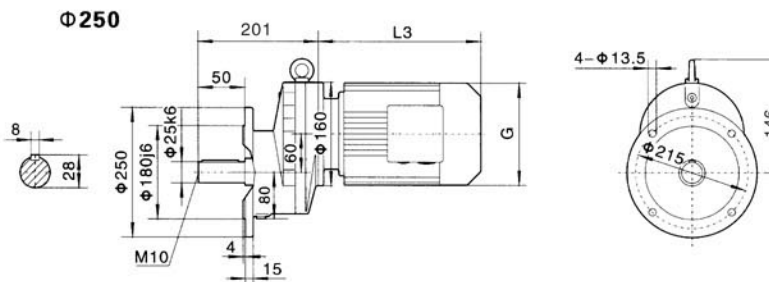
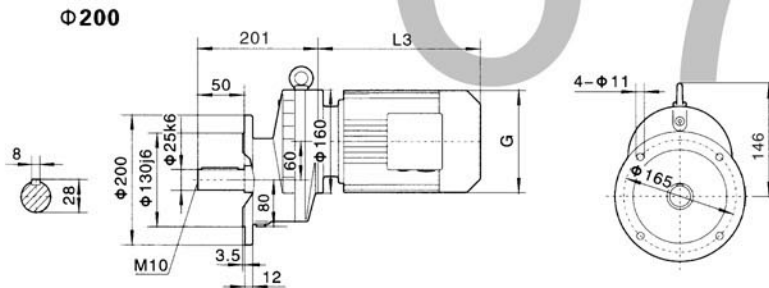
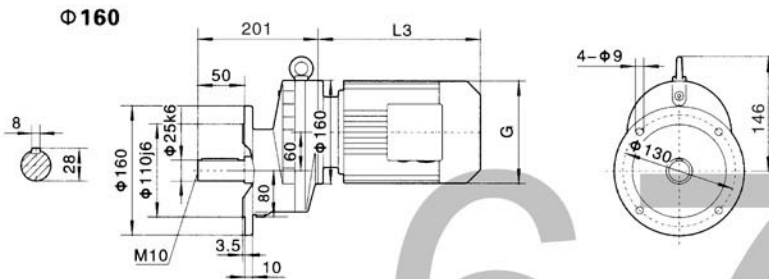

电机需方配时或配特殊电机时需加联接法兰

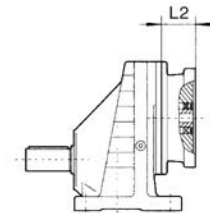

注：其余尺寸见相应的结构形式

Y ₂ 电机机座号	63	71	80	90S	90L	100	112M	132S	132M	
功率/4P(kw)	0.18	0.25 0.37	0.55 0.75	1.1	1.5	2.2 3.0	4.0	5.5	7.5	
L3	223	245	278	304	328	350	380	425	461	
G	130	145	175	195	195	215	240	275	275	
L2	81	81	81	81	81	93	93	101	101	

注：“RX..”表示RX、RFX

外型安装尺寸



RX77

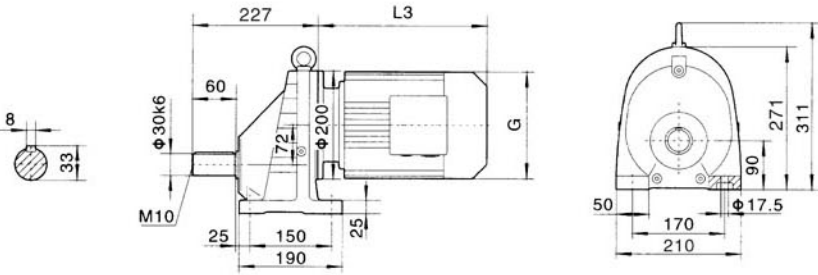

RX..S77

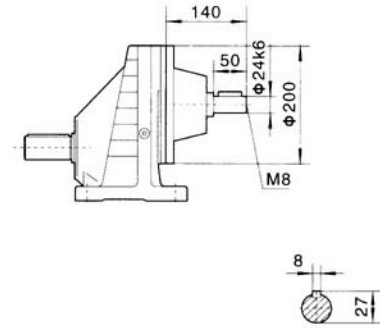

RXF77

Φ200

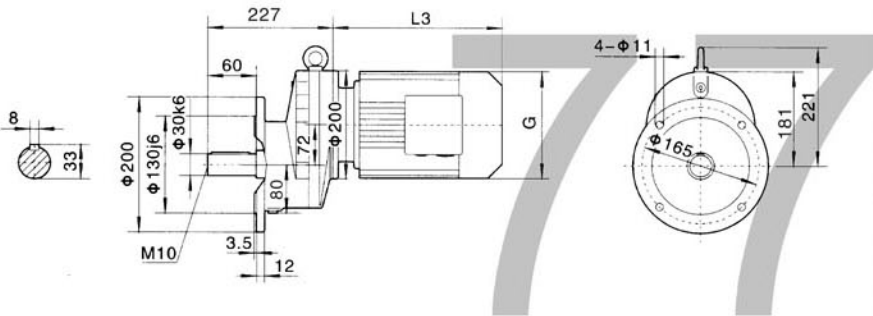

电机需方配时或配特殊电机时需加联接法兰

Φ250

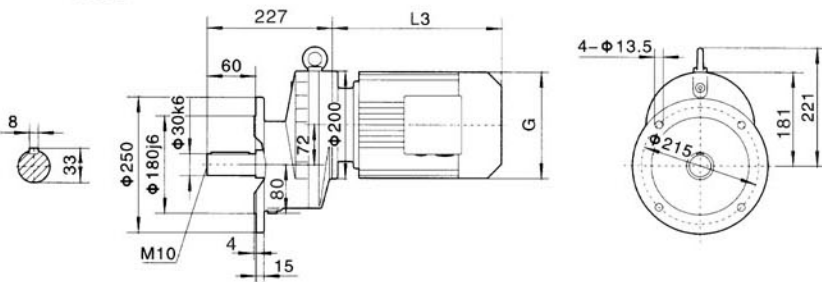

注：其余尺寸见相应的结构形式

	90S	90L	100	112M	132S	132M	160M	
	1.1	1.5	2.2 3.0	4.0	5.5	7.5	11	
L3	304	328	350	380	425	461	524	
G	195	195	215	240	275	275	330	
L2	81	81	93	93	101	101	126	

注：“RX..”表示RX、RFX



外型安装尺寸

R系列减速机

RX87

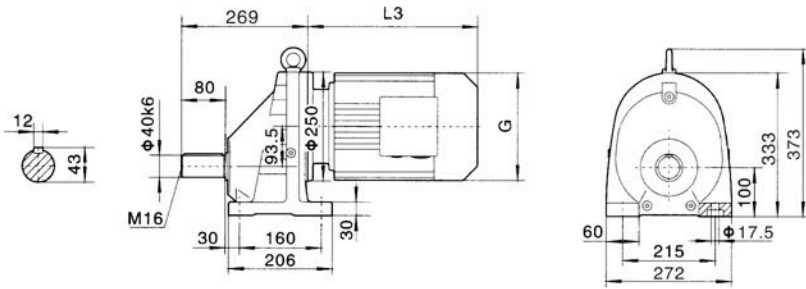

RX..S87

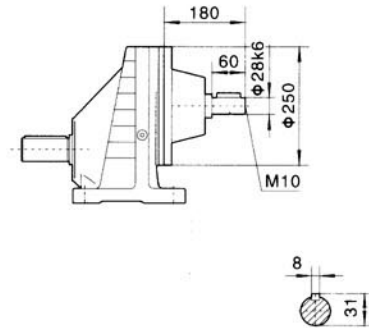

RXF87

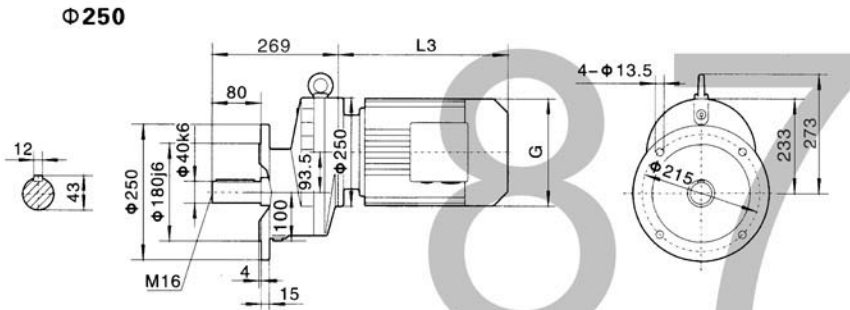

Φ300

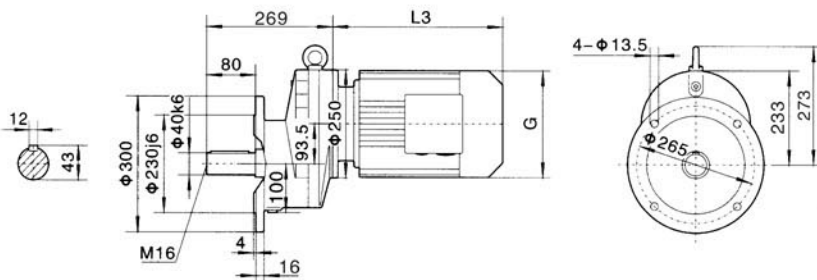

电机需方配时或配特殊电机时需加联接法兰

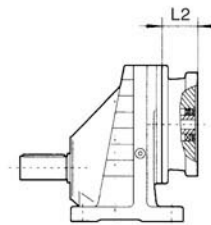

注：其余尺寸见相应的结构形式

Y ₂ 电机机座号	100	112M	132S	132M	160M	160L	180M	180L	
功率/4P(kw)	3.0	4.0	5.5	7.5	11	15	18.5	22	
L3	351	380	425	461	524	547	583	616	
G	215	240	275	275	330	330	380	380	
L2	71	71	101	101	126	126	126	126	

注：“RX..”表示RX、RXF



RX97

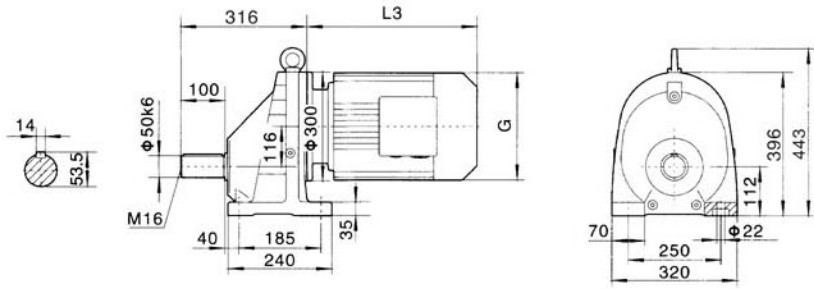

RX..S97

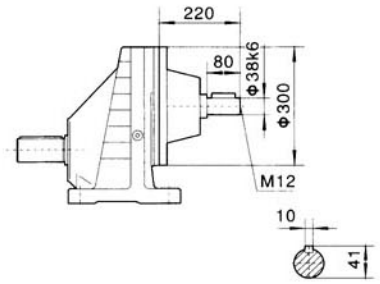

RXF97

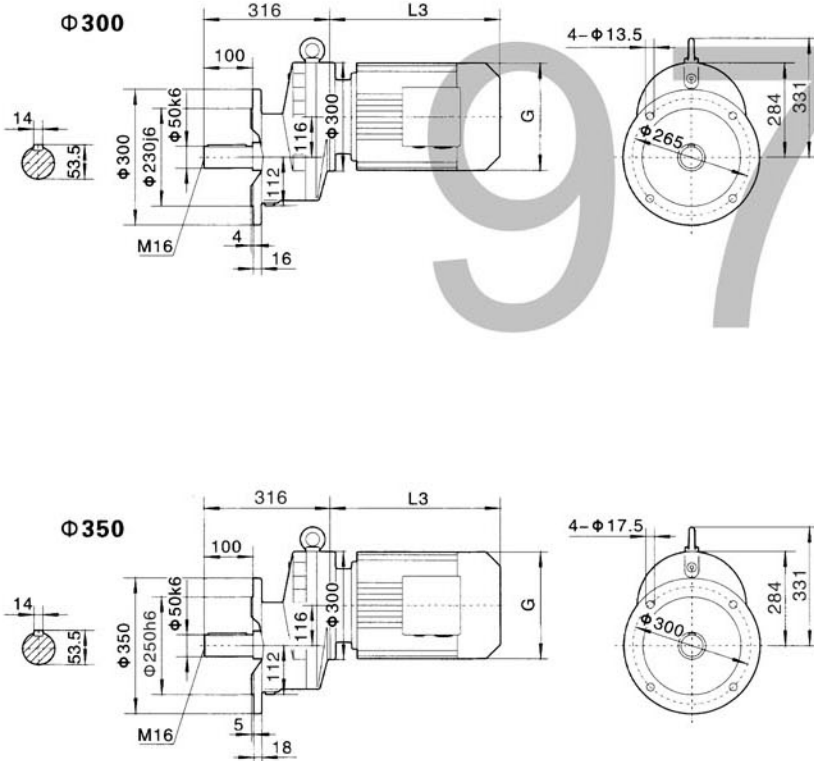

电机需方配时或配特殊电机时需加联接法兰

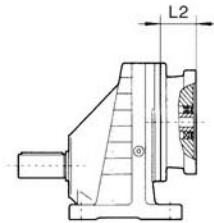

注：其余尺寸见相应的结构形式

Y ₂ 电机机座号	132S	132M	160M	160L	180M	180L	200	
功率/4P(kw)	5.5	7.5	11	15	18.5	22	30	
L3	425	461	524	547	555	588	654	
G	275	275	330	330	380	380	420	
L2	101	101	126	126	126	126	126	

注：“RX..”表示RX、RXF



外型安装尺寸

R系列减速机

RX107

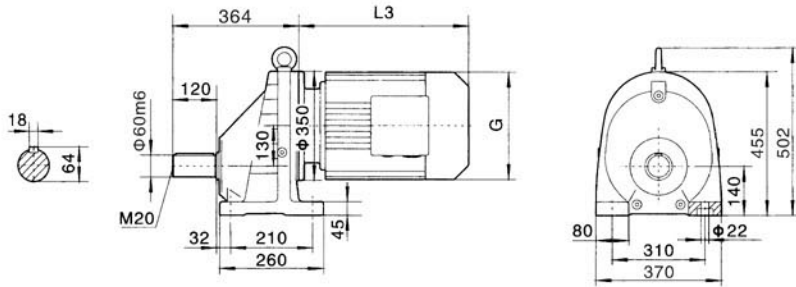

RX..S107

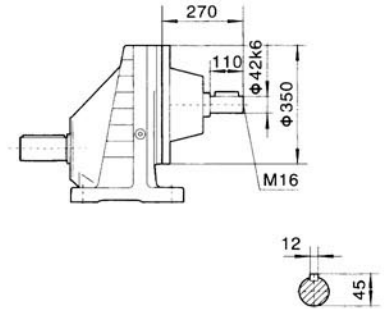

RXF107

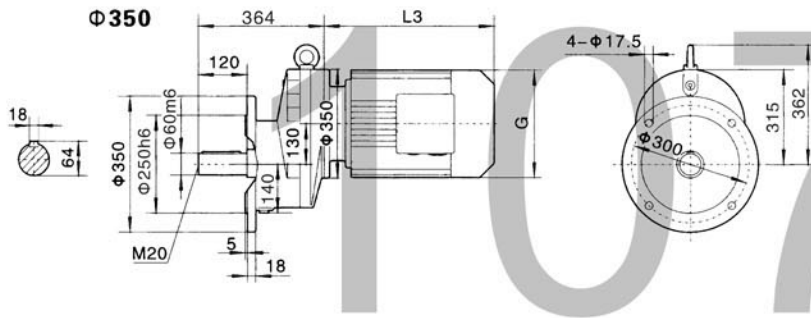

电机需方配时或配特殊电机时需加联接法兰

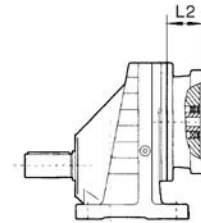

Φ450

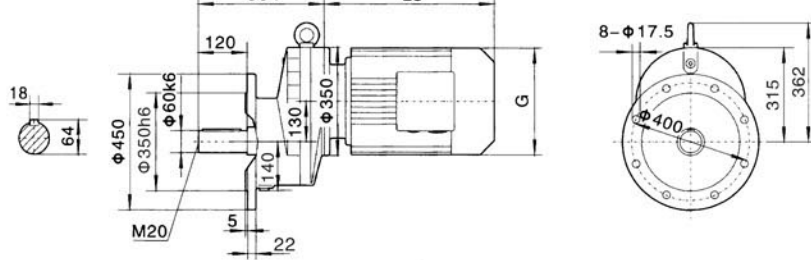

注：其余尺寸见相应的结构形式

Y ₂ 电机机座号	132M	160M	160L	180M	180L	200	225S	225M	
功率/4P(kw)	7.5	11	15	18.5	22	30	37	45	
L3	422	504	519	555	588	654	680	702	
G	275	330	330	380	380	420	470	470	
L2	101	126	126	126	126	132	132	132	

注：“RX..”表示RX、RXF

外型安装尺寸



RX127

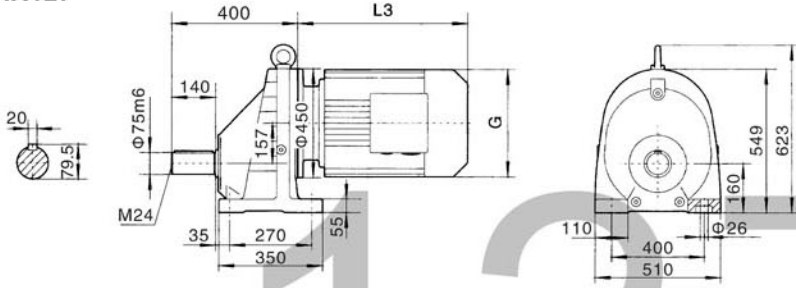

RX..S127

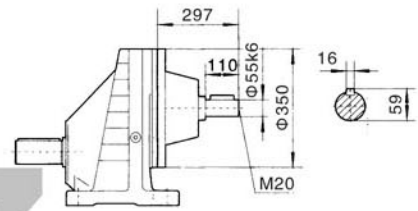

RXF127

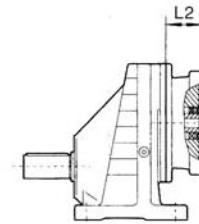
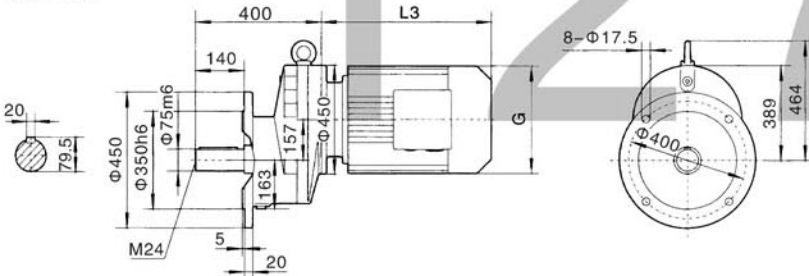

注：其余尺寸见相应的结构形式

Y ₂ 电机机座号	132M	160M	160L	180M	180L	200	225S	225M	250	280S	280M
功率/4P(kw)	7.5	11	15	18.5	22	30	37	45	55	75	90
L3	424	567	602	583	616	654	674	696	775	845	845
G	275	330	330	380	380	420	470	470	510	580	580
L2	132	132	132	132	132	132	143	143	120	120	120

RX157

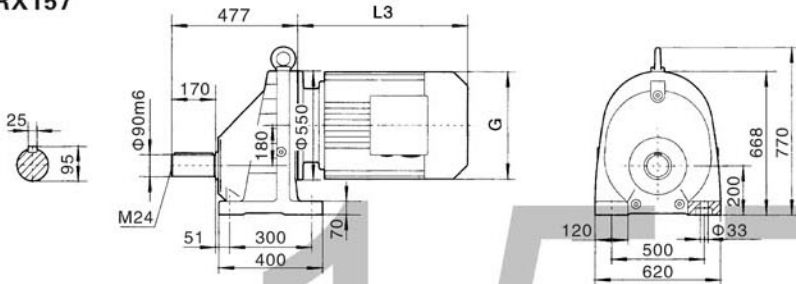

RX..S157

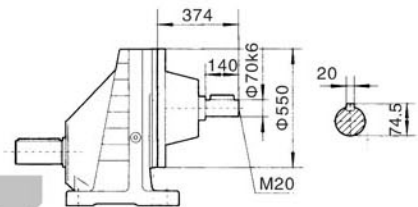

电机需方配时或配特殊电机时需加联接法兰

RXF157

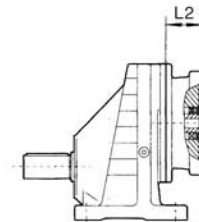
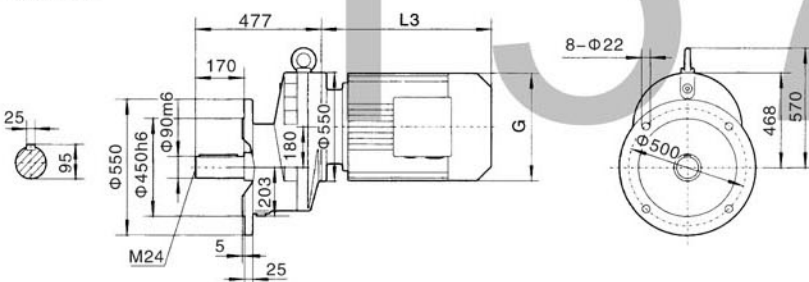

注：其余尺寸见相应的结构形式

Y ₂ 电机机座号	160M	160L	180M	180L	200	225S	225M	250	280S	280M	315S	315M
功率/4P(kw)	11	15	18.5	22	30	37	45	55	75	90	110	132
L3	567	602	635	666	642	669	691	770	828	879	1100	1130
G	330	330	380	380	420	470	470	510	580	580	645	645
L2	143	143	143	143	143	143	143	143	143	143	145	145

注：“RX..”表示RX、RFX



外型安装尺寸

R系列减速机

R17

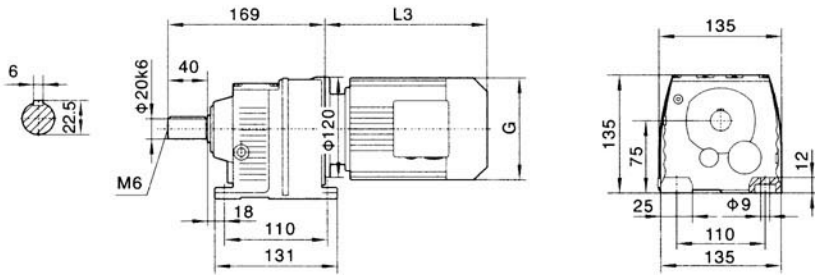

电机需方配时或配特殊电机时需加联接法兰

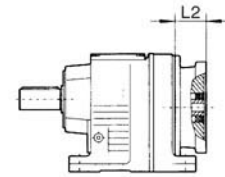

注：其余尺寸见相应的结构形式

RF17

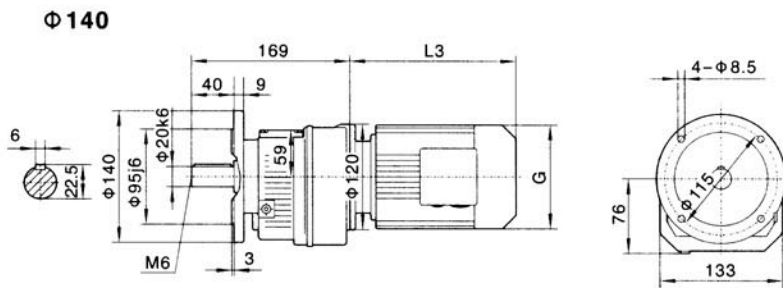
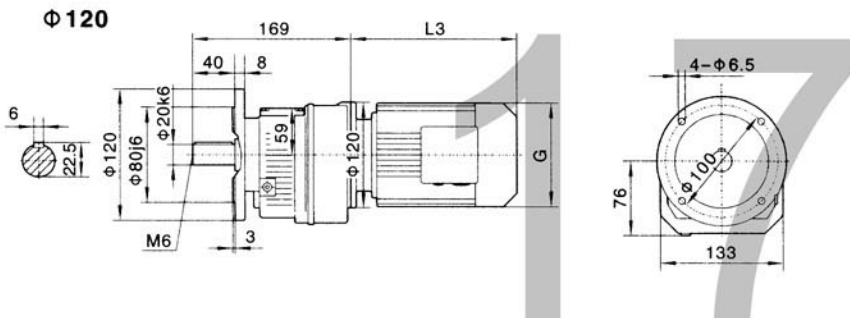

Y ₂ 电机机座号	63	71		80									
功率/4P(kw)	0.18	0.25	0.37	0.55	0.75								
L3	235	245		278									
G	130	145		175									
L2	71	71		71									

注：“R..”表示R、RF



R27

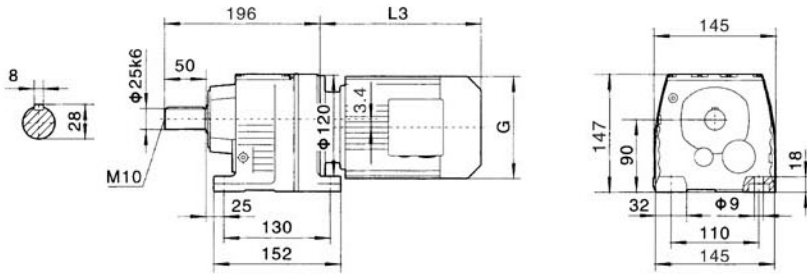

电机需方配时或配特殊电机时需加联接法兰

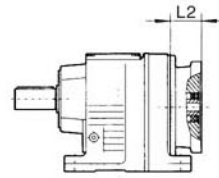

RF27

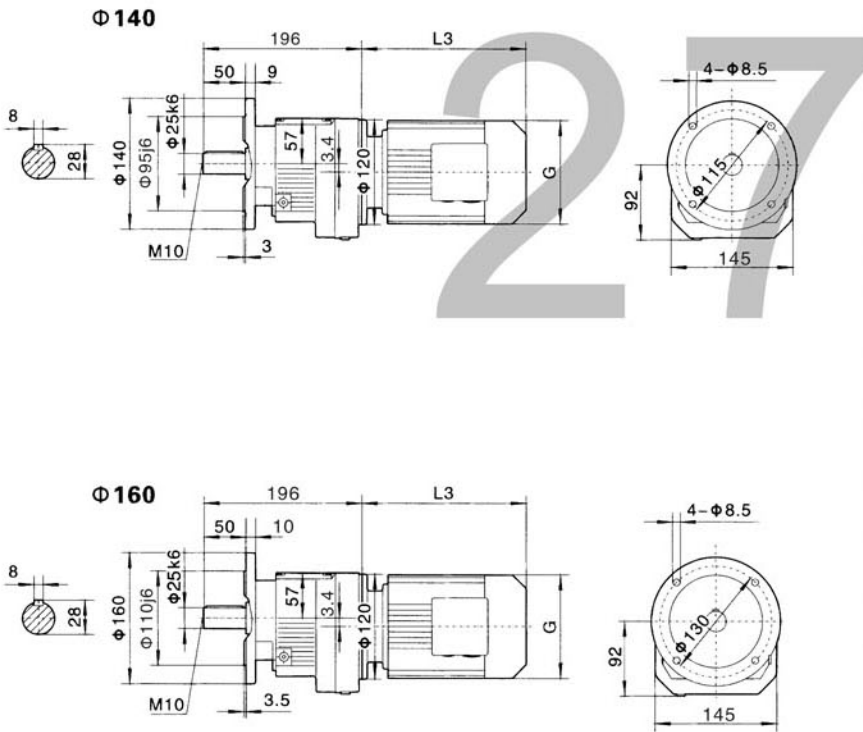

R..S27

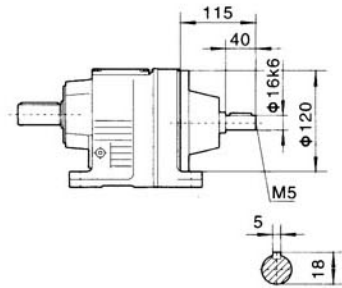

R..27R17

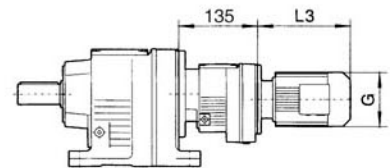

注：其余尺寸见相应的结构形式

Y ₂ 电机机座号	63	71	80	90S	90L	100	
功率/4P(kw)	0.18	0.25 0.37	0.55 0.75	1.1	1.5	2.2 3.0	
L3	235	245	278	304	328	340	
G	130	145	175	195	195	215	
L2	71	71	71	71	71	93	

注：“R..”表示R、RF



外型安装尺寸

R系列减速机

R37

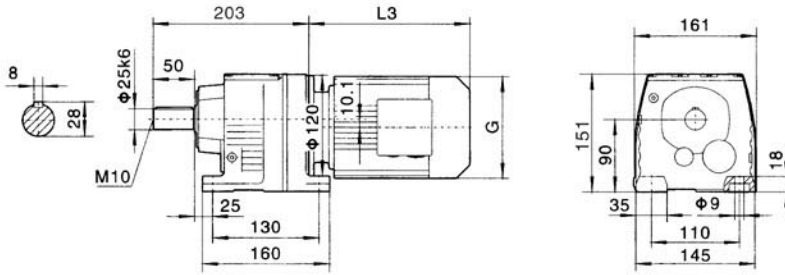

电机需方配时或配特殊电机时需加联接法兰

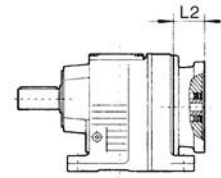

RF37

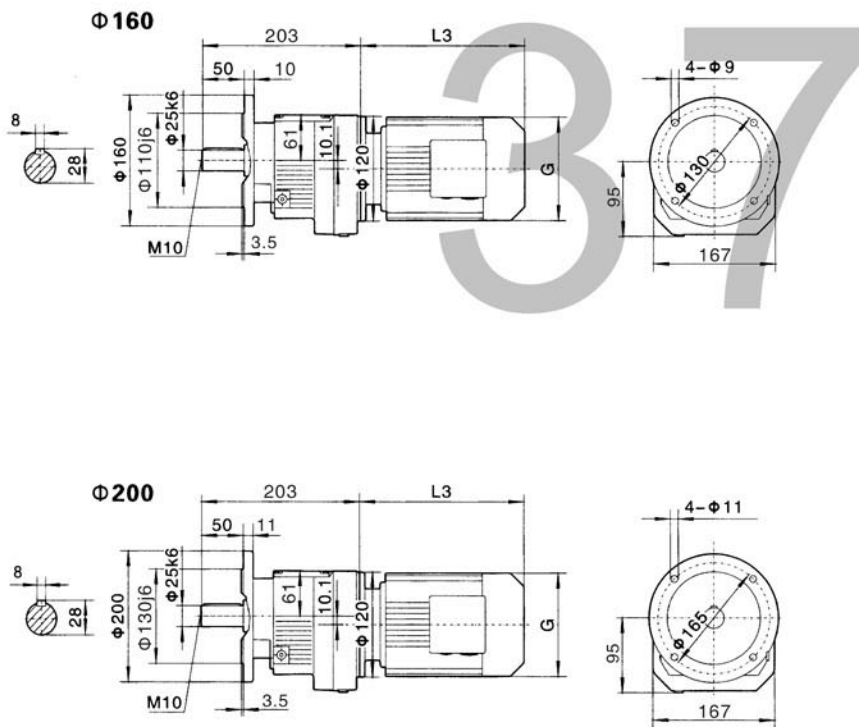

R..S37

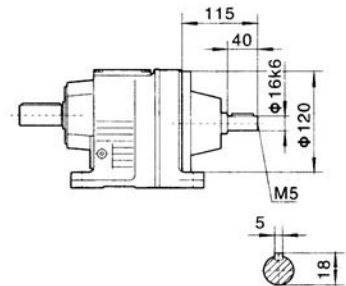

R..37R17

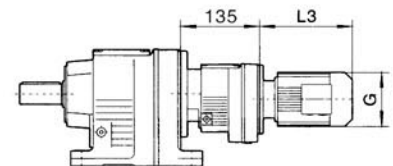

注：其余尺寸见相应的结构形式

Y ₂ 电机机座号	63	71		80	90S	90L	100L	
功率/4P(kw)	0.18	0.25	0.37	0.55	0.75	1.1	1.5	2.2 3.0
L3	235	245		278	304	328	340	
G	130	145		175	195	195	215	
L2	71	71		71	71	71	93	

注：“R..”表示R、RF



R47

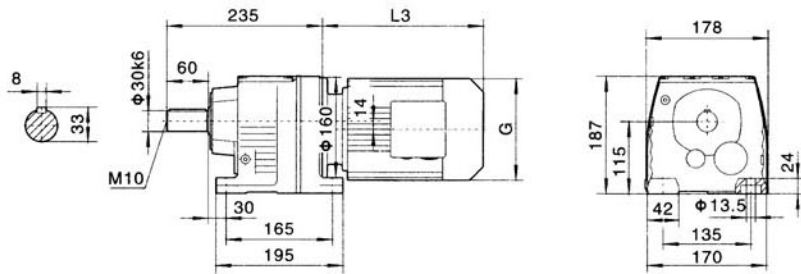

电机需方配时或配特殊电机时需加联接法兰

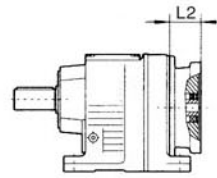

RF47

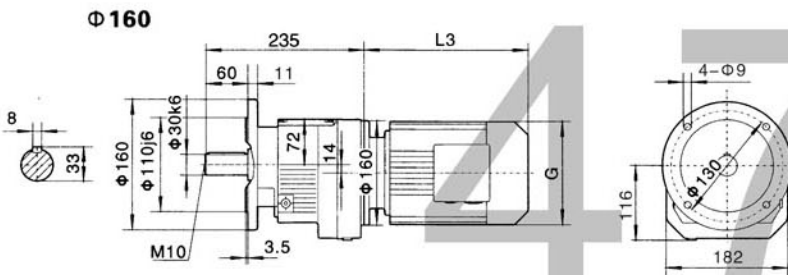

R..S47

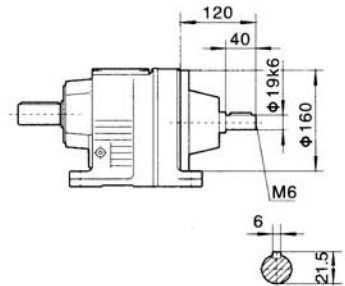

R..47R37

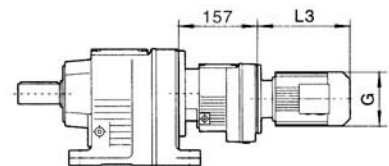

注：其余尺寸见相应的结构形式

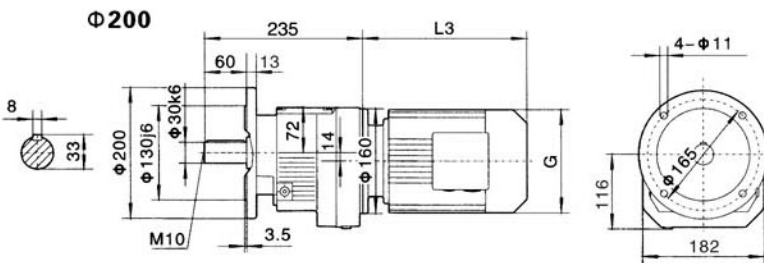

Y ₂ 电机机座号	63	71	80	90S	90L	100	112M	132S	
功率/4P(kw)	0.18	0.25 0.37	0.55 0.75	1.1	1.5	2.2 3.0	4.0	5.5	
L3	223	245	278	304	328	350	380	425	
G	130	145	175	195	195	215	240	275	
L2	81	81	81	81	81	93	93	101	

注：“R..”表示R、RF



外型安装尺寸

R系列减速机

R57

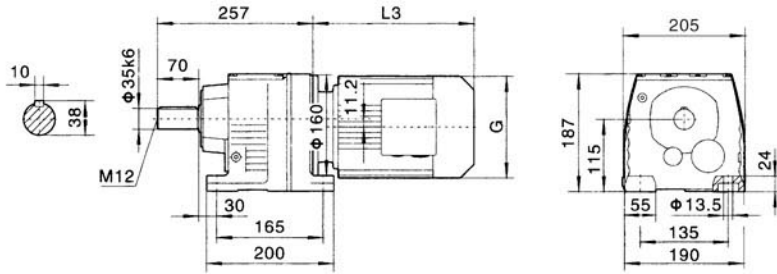

电机需方配时或配特殊电机时需加联接法兰

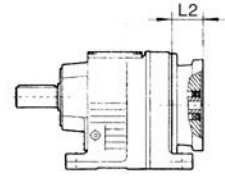

RF57

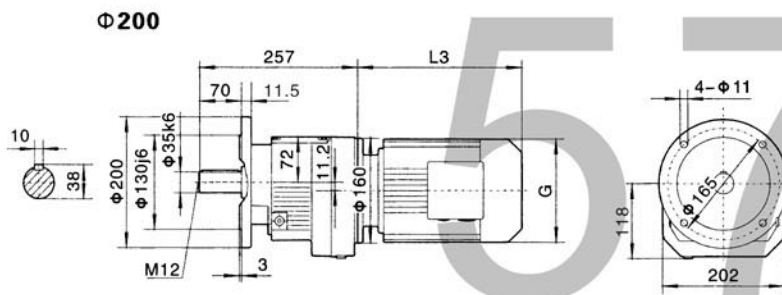

R..S57

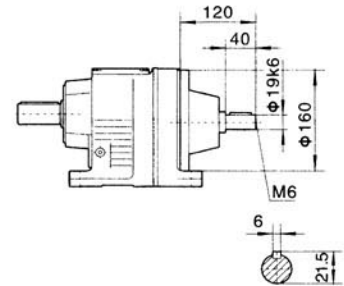

Φ250

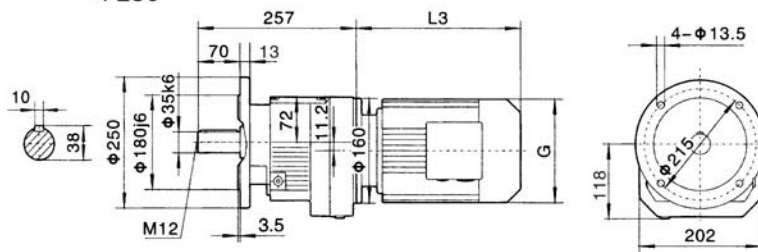

R..57R37

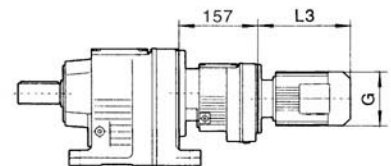

注：其余尺寸见相应的结构形式

Y ₂ 电机机座号	63	71	80	90S	90L	100L	112M	132S	132M	
功率/4P(kw)	0.18	0.25 0.37	0.55 0.75	1.1	1.5	2.2 3.0	4.0	5.5	7.5	
L3	223	245	278	304	328	350	380	425	461	
G	130	145	175	195	195	215	240	275	275	
L2	81	81	81	81	81	93	93	101	101	

注：“R..”表示R、RF



R67

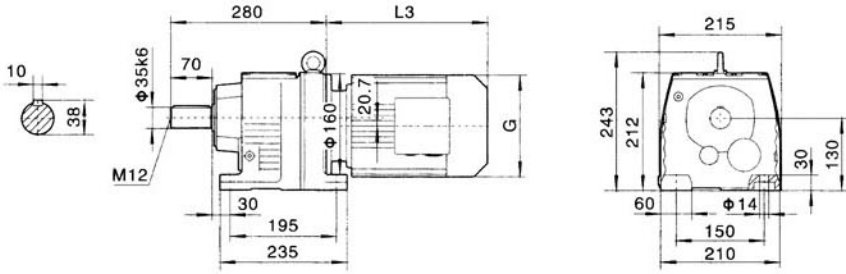

电机需方配时或配特殊电机时需加联接法兰

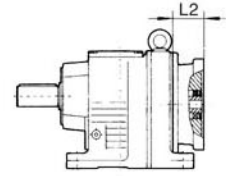

RF67

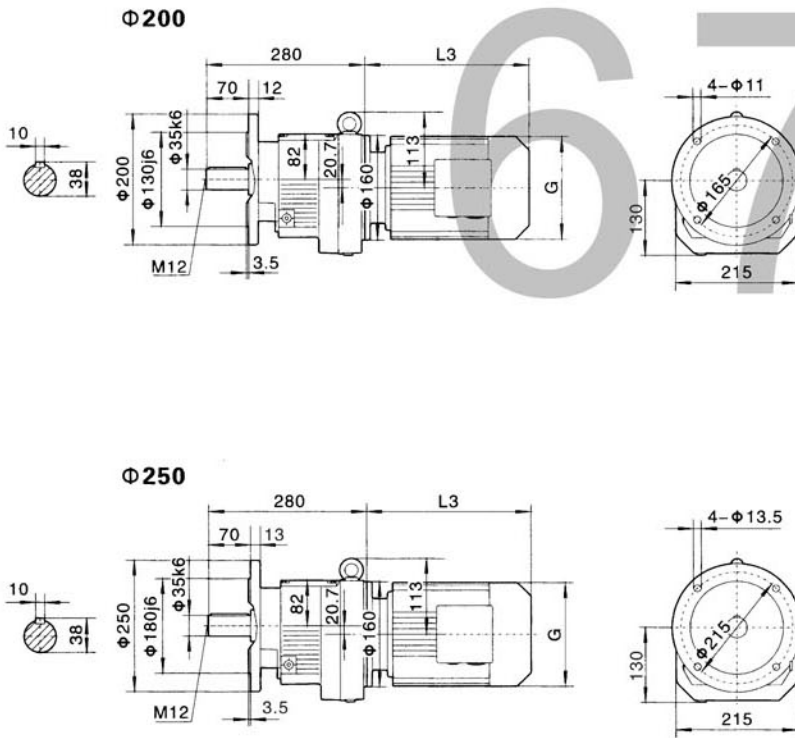

R..S67

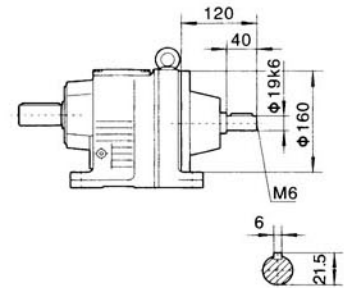

R..67R37

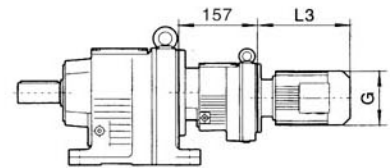

注：其余尺寸见相应的结构形式

Y ₂ 电机机座号	63	71	80	90S	90L	100L	112M	132S	132M	
功率/4P(kw)	0.18	0.25 0.37	0.55 0.75	1.1	1.5	2.2 3.0	4.0	5.5	7.5	
L3	223	245	278	304	328	350	380	425	461	
G	130	145	175	195	195	215	240	275	275	
L2	81	81	81	81	81	93	93	101	101	

注：“R..”表示R、RF



外型安装尺寸

R系列减速机

R77

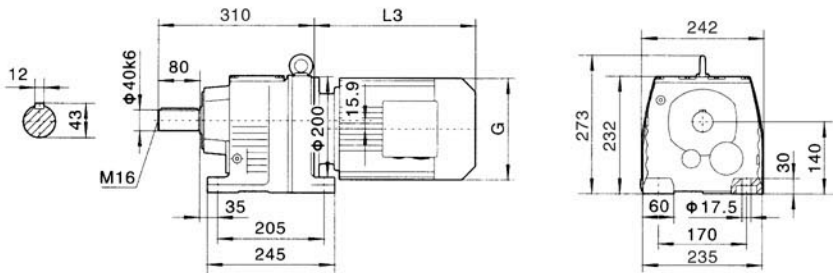

电机需方配时或配特殊电机时需加联接法兰

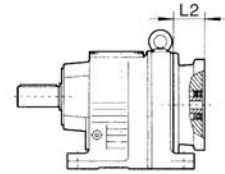

RF77

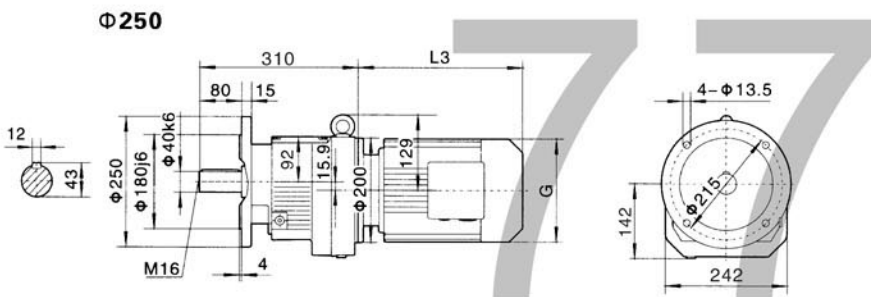

R..S77

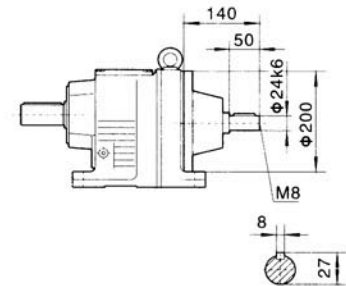

R..77R37

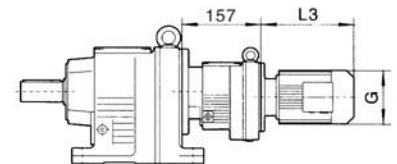

φ300

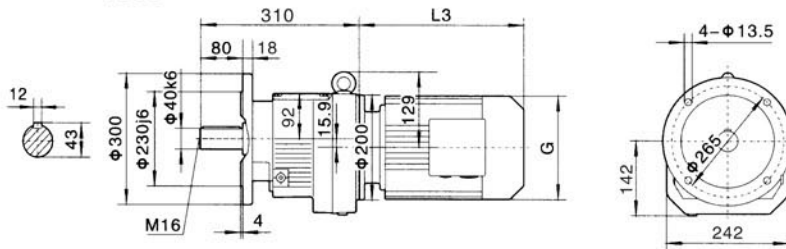

注：其余尺寸见相应的结构形式

Y ₂ 电机机座号	63	71	80	90S	90L	100L	112M	132S	132M	160M
功率/4P(kw)	0.18	0.25 0.37	0.55 0.75	1.1	1.5	2.2 3.0	4.0	5.5	7.5	11
L3	223	233	278	304	328	350	380	425	461	524
G	130	145	175	195	195	215	240	275	275	330
L2	81	81	81	81	81	93	93	101	101	126

注：“R..”表示R、RF



R87

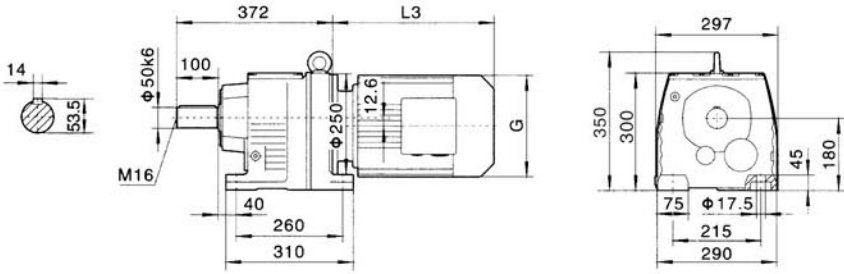

电机需方配时或配特殊电机时需加联接法兰

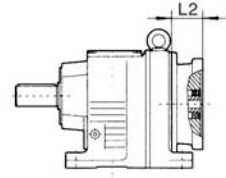

RF87

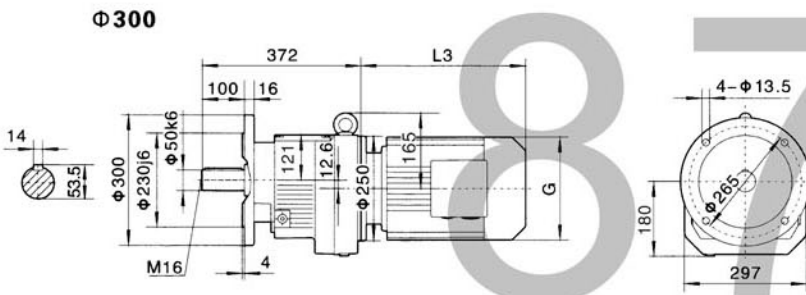

R..S87

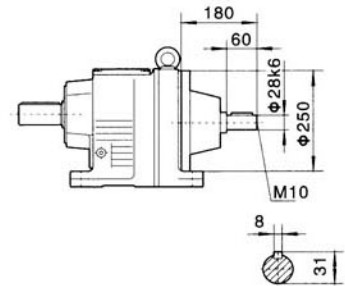

350

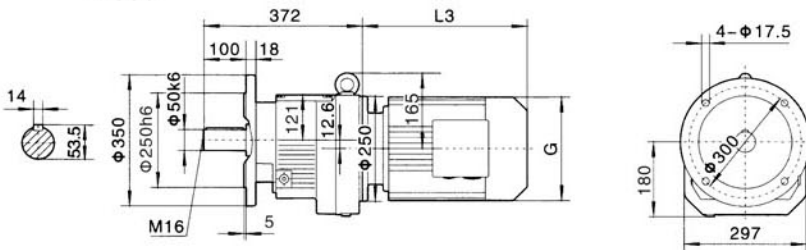

R..87R37

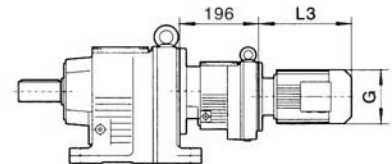

注：其余尺寸见相应的结构形式

Y ₂ 电机机座号	80	90S	90L	100	112M	132S	132M	160M	160L	180M	180L
功率/4P(kw)	0.55 0.75	1.1	1.5	2.2 3.0	4.0	5.5	7.5	11	15	18.5	22
L3	246	280	304	350	380	425	461	524	547	583	616
G	175	195	195	215	240	275	275	330	330	380	380
L2	86	86	86	71	71	101	101	126	126	126	126

注：“R..”表示R、RF



外型安装尺寸

R系列减速机

R97

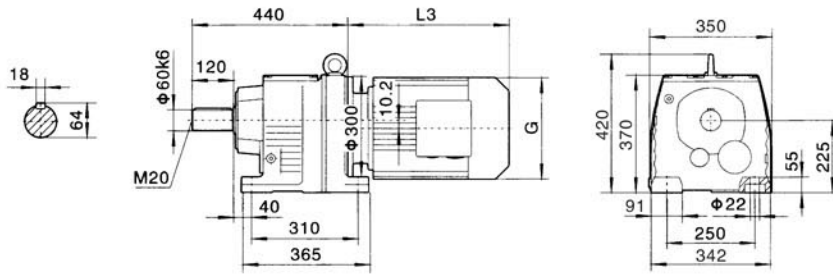

电机需方配时或配特殊电机时需加联接法兰

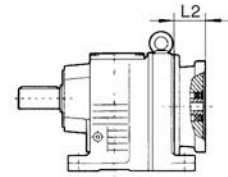

RF97

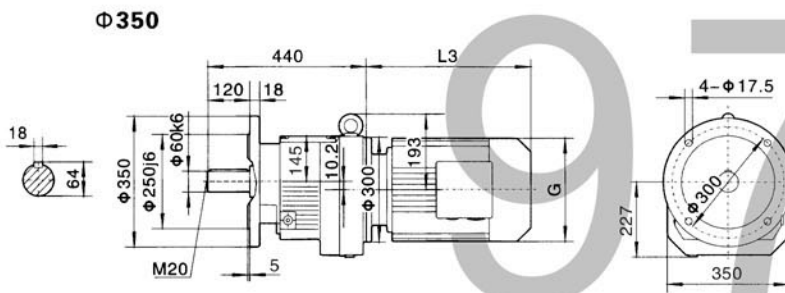

R..S97

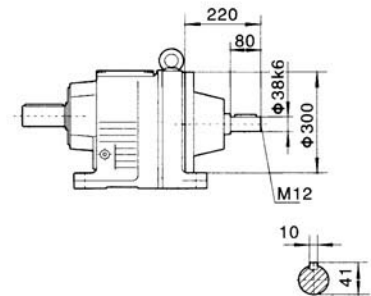

Φ450

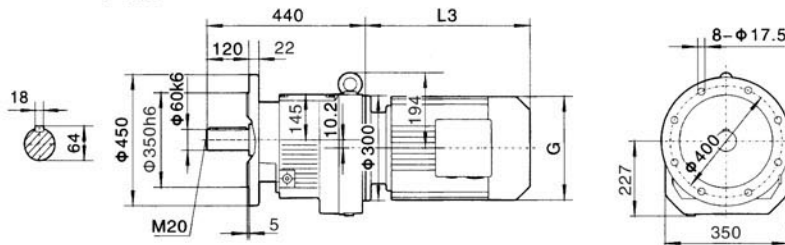

R..97R57

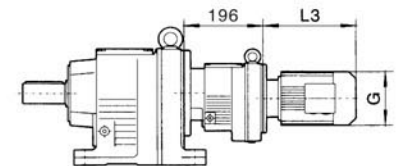

注：其余尺寸见相应的结构形式

Y ₂ 电机机座号	80	90S	90L	100	112M	132S	132M	160M	160L	180M	180L	200
功率/4P(kw)	0.55 0.75	1.1	1.5	2.2 3.0	4.0	5.5	7.5	11	15	18.5	22	30
L3	246	280	304	315	334	425	461	524	547	555	588	654
G	175	195	195	215	240	275	275	330	330	380	380	420
L2	86	86	86	101	101	101	101	126	126	126	126	132

注：“R..”表示R、RF

外型安装尺寸



R107

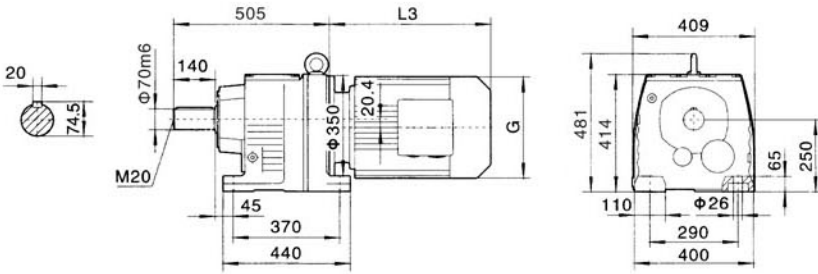

电机需方配时或配特殊电机时需加联接法兰

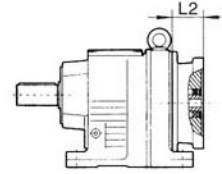

RF107

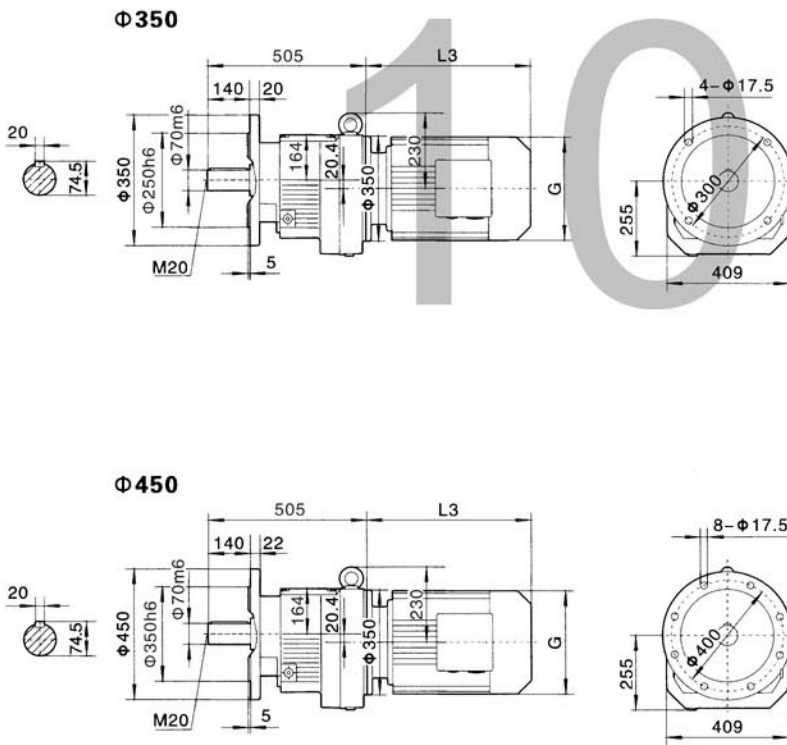

R..S107

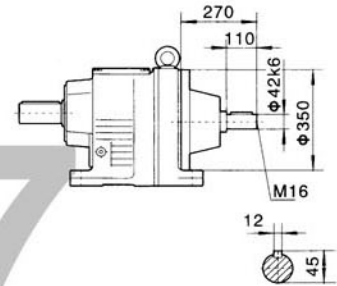

R..107R77

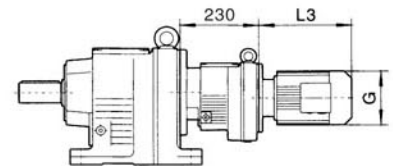

注：其余尺寸见相应的结构形式

Y ₂ 电机机座号	100	112M	132S	132M	160M	160L	180M	180L	200	225S	225M	
功率/4P(kw)	2.2	3.0	4.0	5.5	7.5	11	15	18.5	22	30	37	45
L3	318	334	386	422	504	519	555	588	654	680	702	
G	215	240	275	275	330	330	380	380	420	470	470	
L2	101	101	101	101	126	126	126	126	132	132	132	

注：“R..”表示R、RF



外型安装尺寸

R137

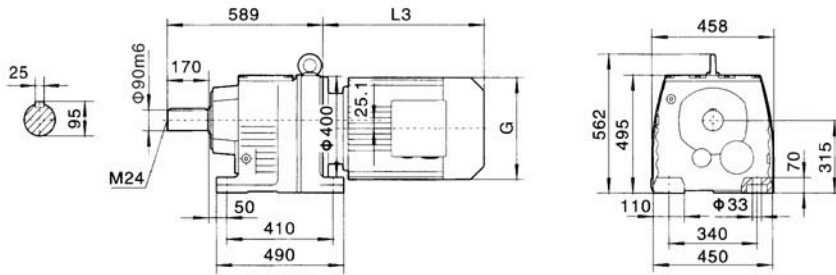

电机需方配时或配特殊电机时需加联接法兰

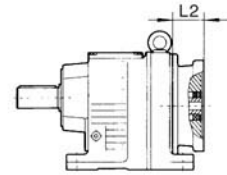

RF137

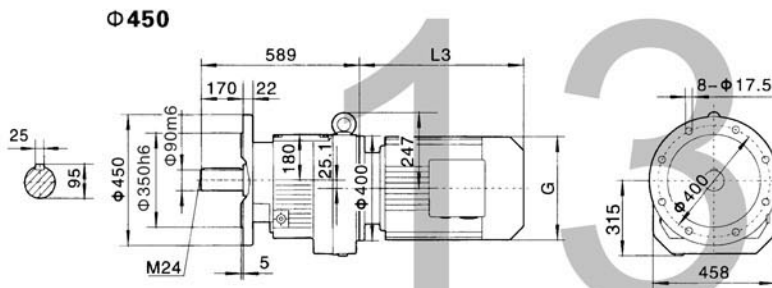

R..S137

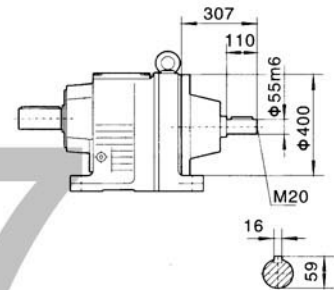

R..137R77

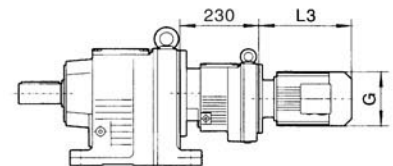

φ550

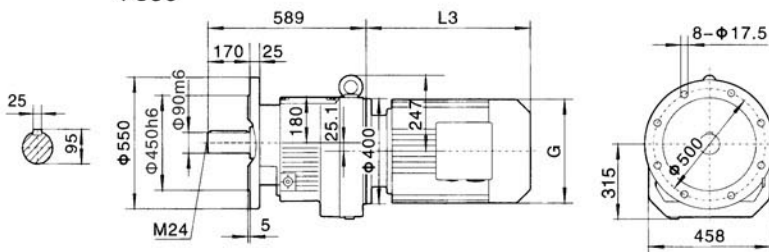

注：其余尺寸见相应的结构形式

Y ₂ 电机机座号	132S	132M	160M	160L	180M	180L	200	225S	225M	250	
功率/4P(kw)	5.5	7.5	11	15	18.5	22	30	37	45	55	
L3	388	424	476	519	555	588	654	680	702	771	
G	275	275	330	330	380	380	420	470	470	510	
L2	126	126	132	132	132	132	132	143	143	174	

注：“R..”表示R、RF

外型安装尺寸



R147

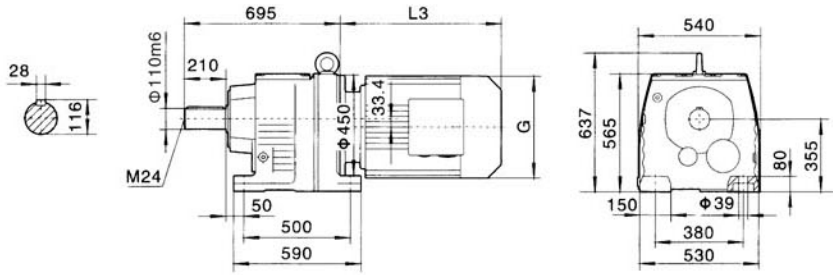

电机需方配时或配特殊电机时需加联接法兰

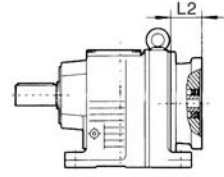

RF147

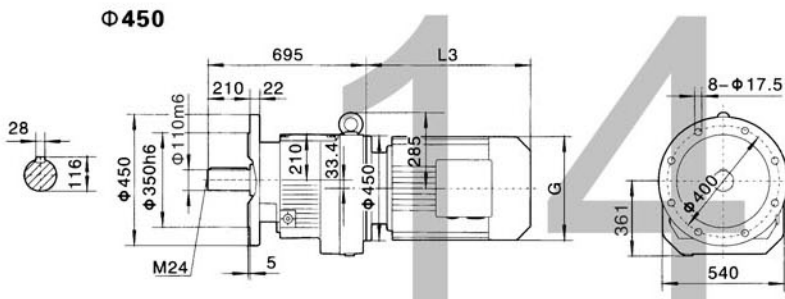

R..S147

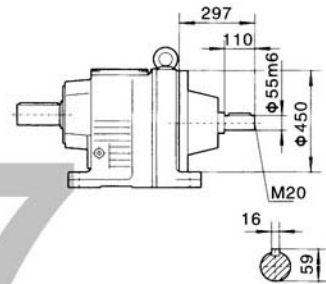

R..147R87(R77)

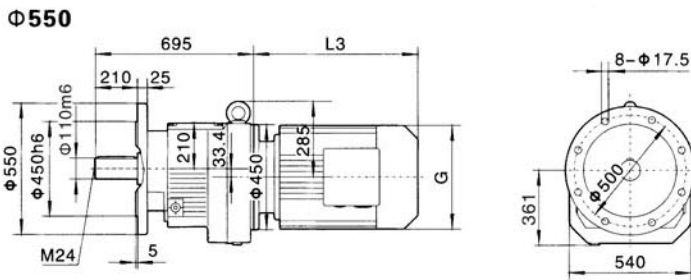
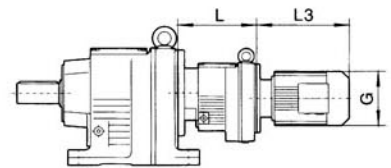

	R..147R77组合	R..147R87组合
L	226	275

注：其余尺寸见相应的结构形式

Y ₂ 电机机座号	160M	160L	180M	180L	200	225S	225M	250	280S	280M	
功率/4P(kw)	11	15	18.5	22	30	37	45	55	75	90	
L3	567	602	583	616	654	674	696	775	845	845	
G	330	330	380	380	420	470	470	510	580	580	
L2	132	132	132	132	132	143	143	174	174	174	

注：“R..”表示R、RF



外型安装尺寸

R系列减速机

R167

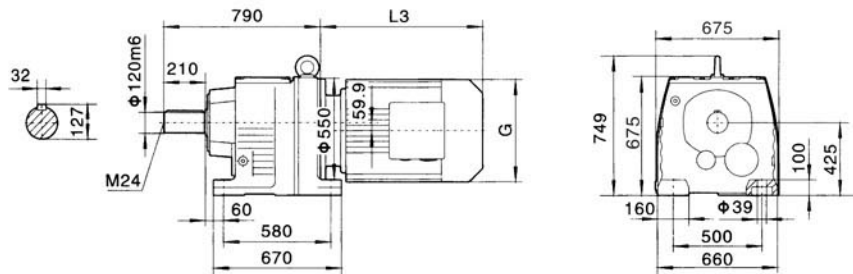

电机需方配时或配特殊电机时需加联接法兰

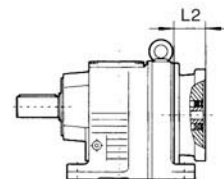

RF167

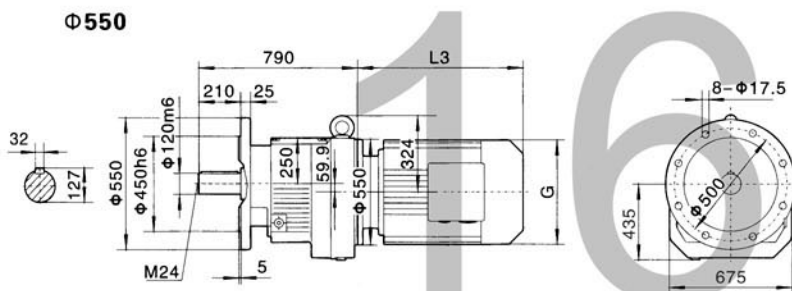

R..S167

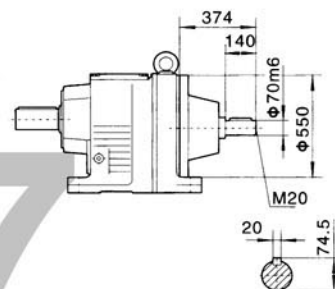

R..167R97(R107)

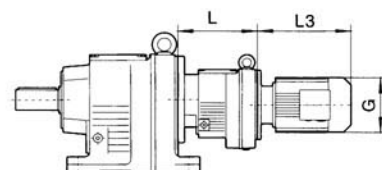

φ660

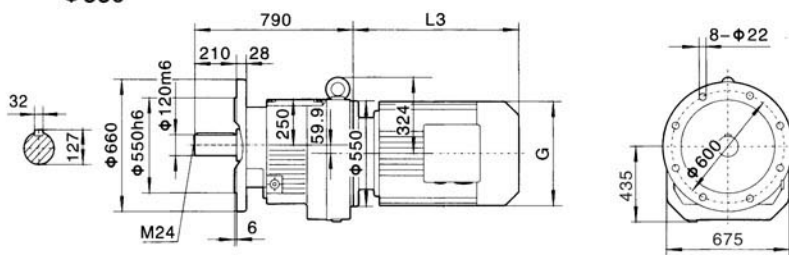

	R..167R97组合	R..167R107组合
L	320	370

注：其余尺寸见相应的结构形式

Y ₂ 电机机座号	160M	160L	180M	180L	200	225S	225M	250	280S	280M	315S	315M	315L
功率/4P(kw)	11	15	18.5	22	30	37	45	55	75	90	110	132	160
L3	567	602	635	666	642	669	691	770	828	879	1100	1130	1360
G	330	330	380	380	420	470	470	510	580	580	645	645	645
L2	143	143	143	143	143	143	143	113	113	113	113	145	145

注：“R..”表示R、RF